

APPENDIX 3

Key:

- Existing TRO No Waiting Mon - Fri 08:30 - 09:30, 14:30 - 16:00
- School Zig Zag markings
- Existing TRO (No Waiting Mon - Fri 08:30 - 09:30, 14:30 - 16:00) change to Mon - Fri 07:30 - 09:30, 14:30 - 16:00. Introduction of 'No Loading at Any Time' Mon - Fri 07:30 - 09:30, 14:30 - 16:00
- Manchester Bollard
- Dropped Kerb
- Realigned Path

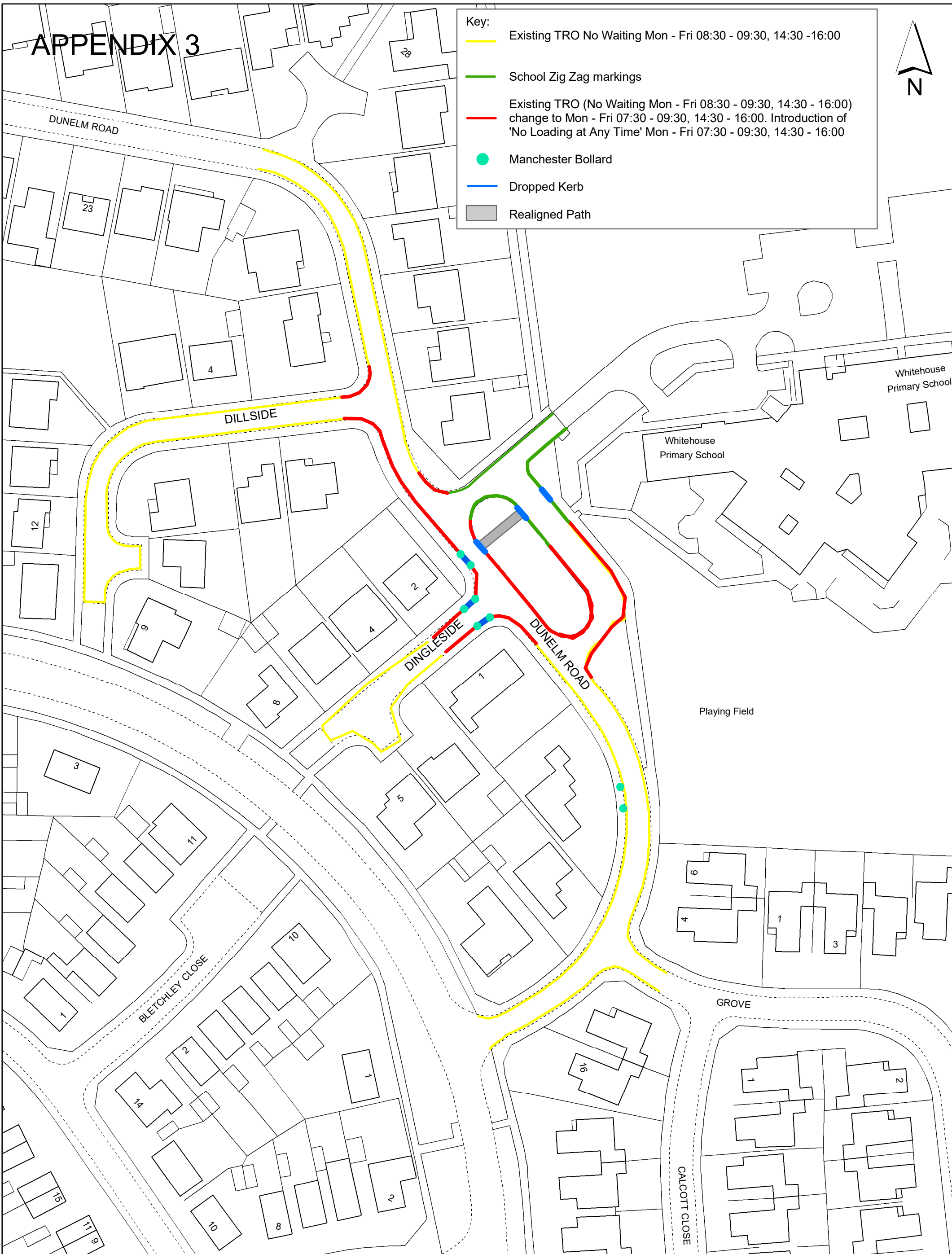

Stockton-on-Tees
BOROUGH COUNCIL

© Crown Copyright and database right 2017
Ordnance Survey 100023297

Economic Growth and Development
Director: Richard McGuckin
PO Box 229, Kingsway House
Billingham, TS23 2YL
Telephone: (01642) 393939

Date **October 2018** Drg No. **TM2/269**

Whitehouse Primary School
Dunelm Road, Elm Tree Farm,
Stockton

Scale **1:800**